

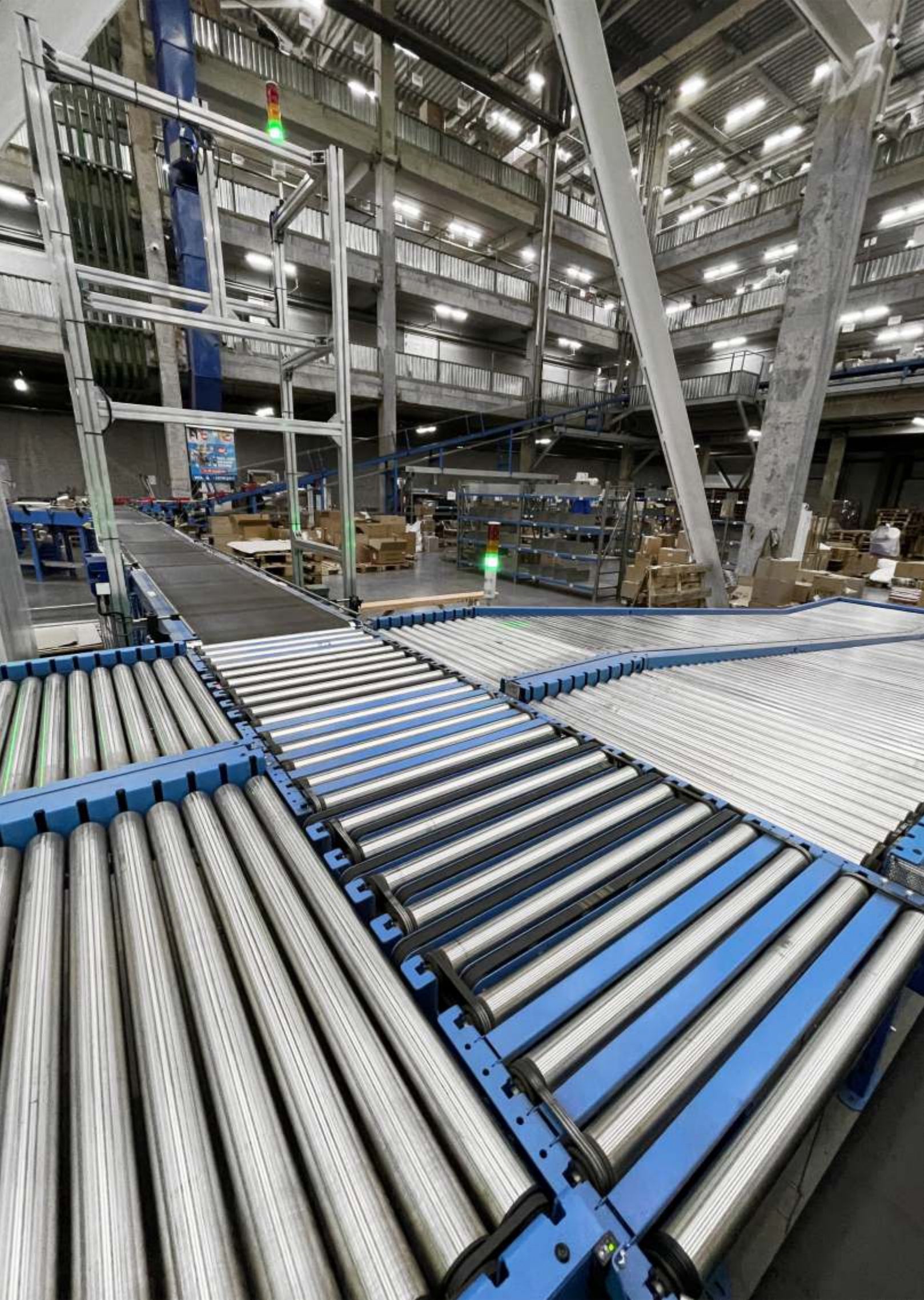

CONVEYOR ROLLERS

EXCELLENT QUALITY
AND RELIABILITY





RANGE OF APPLICATION



Packaging and logistics

Used in warehouses requiring high-speed cargo handling and maximum efficiency with minimal floor space occupancy.



Distribution centers and warehousing

When high performance, accuracy, reliability, as well as high process dynamics are required



Distribution of Pharmaceutical Products

Allow automatic order picking, packaging, and screening for picking errors.



Mail, parcels, and e-commerce

Allow for rapid sorting where it is critically important.

ROLLER TYPES:

GRAVITY
ROLLERS

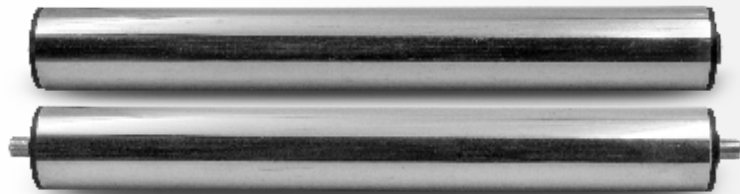

DRIVE
ROLLERS



MOTOR
ROLLERS



END TYPES AND MOUNTING DESIGN:

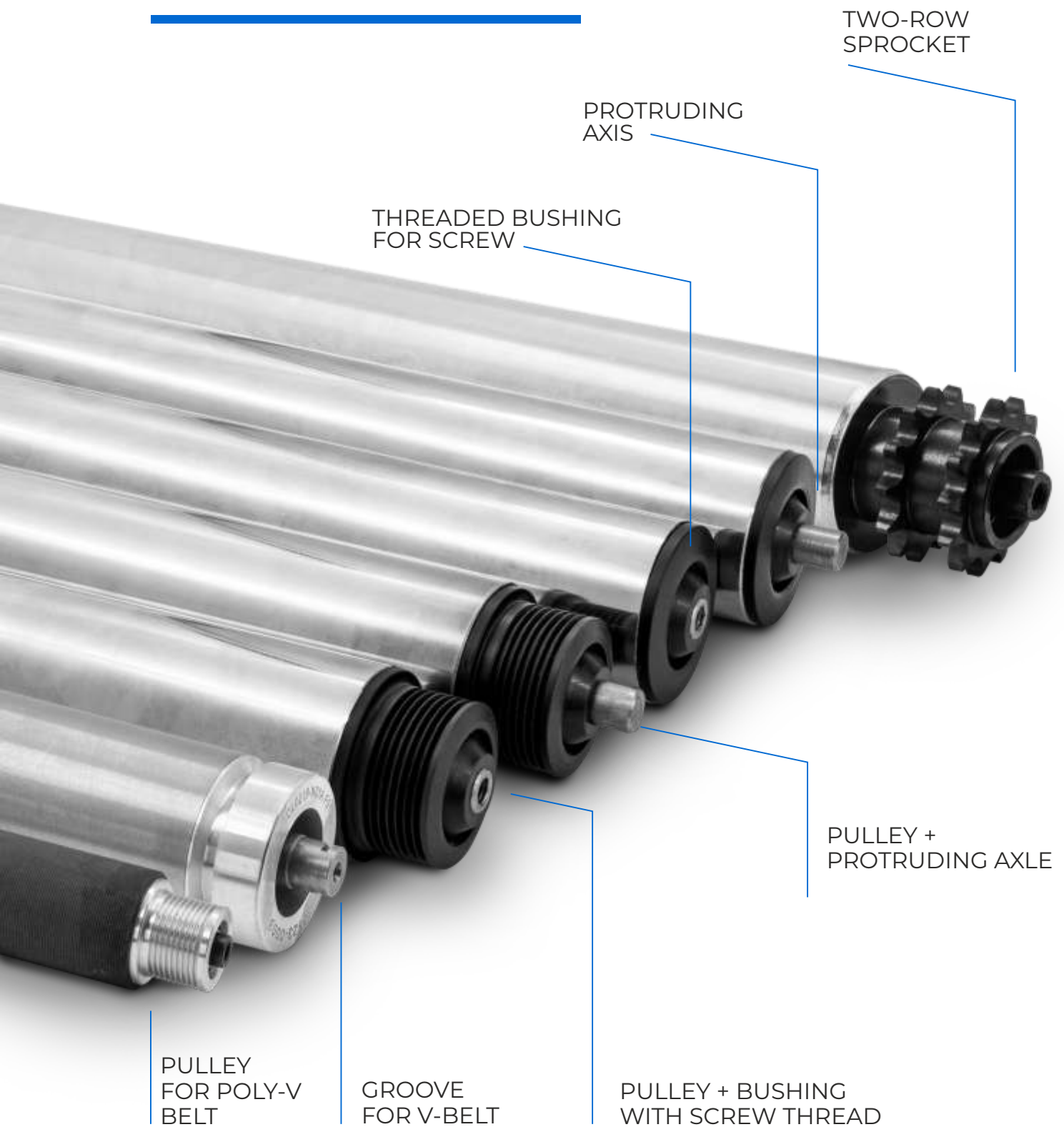

MOTOR ROLLER

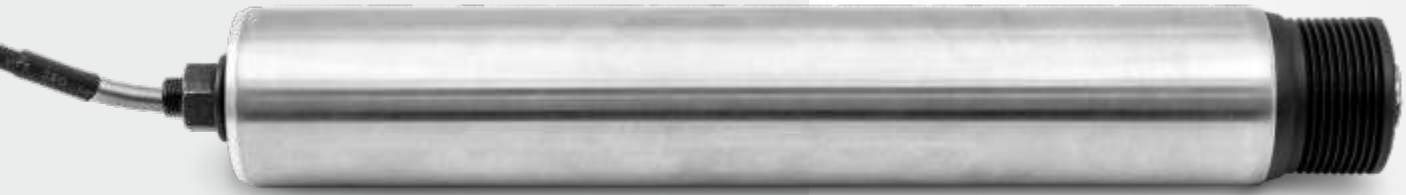

TECHNICAL SPECIFICATIONS

Power	—	60 W
Voltage	—	24V
Speed	—	8-60 m/min
Load capacity	—	up to 100 kg
Manufacturing material	—	stainless steel



PULLEY FOR POLY-V BELT

Profile	—	PJ
Number of groves	—	7
Grove pitch	—	2.34
Belt thickness	—	3.3

OPERATING CONDITIONS

Temperature	from -10 to +40
Storage temperature	from -30 to +75
Maximum humidity	90%

DIMENSIONS

Diameter	50 mm
Length	300 - 800 mm

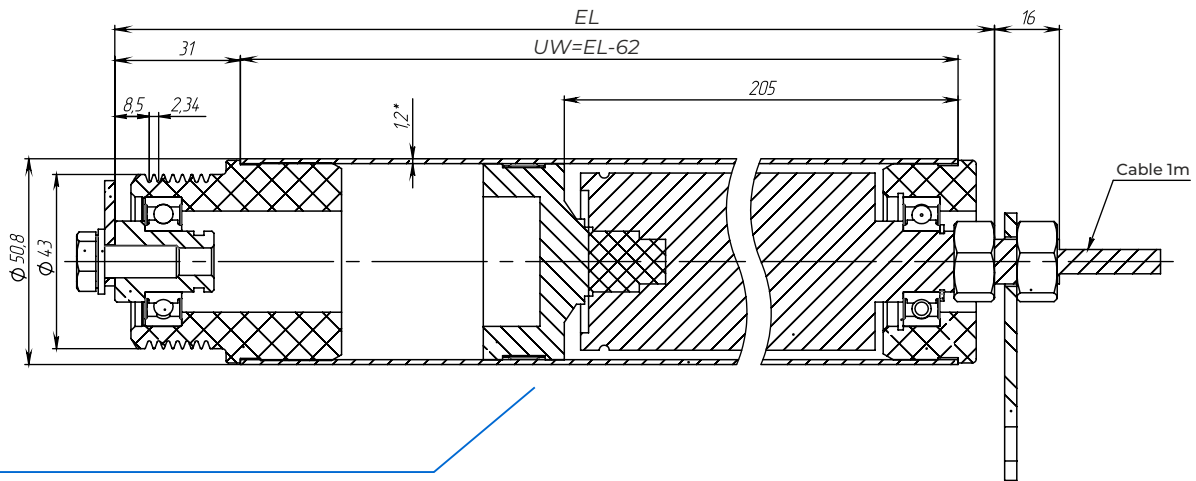

ROLLER

MOUNTING NUT

MOUNTING SCREW

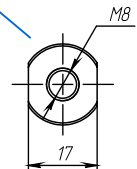
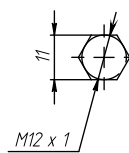
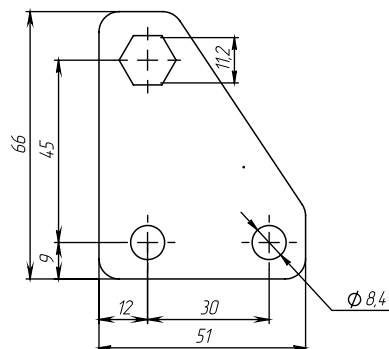

BRACKET

MOTOR ROLLER

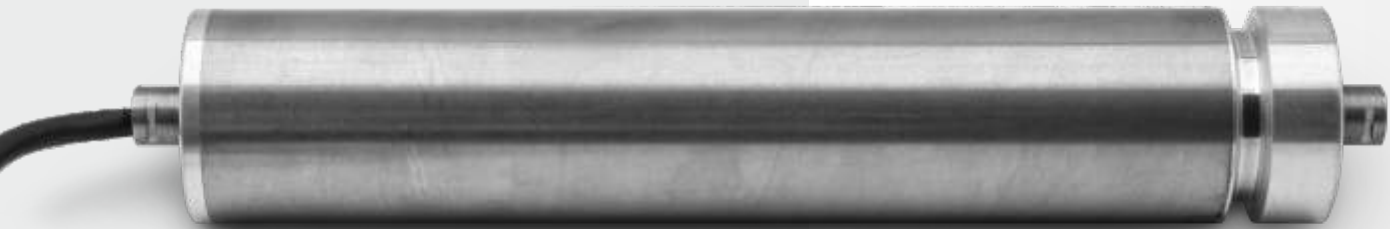

TECHNICAL SPECIFICATIONS

Power	—	150 W
Voltage	—	48 V
Speed	—	150-850 m/min
Load capacity	—	up to 100 kg
Manufacturing material	—	stainless steel



GROOVE FOR V-BELT

Profile	—	3VX/9NX
Width	—	9 mm
Height	—	8 mm

OPERATING CONDITIONS

Temperature	from -10 to +40
Storage temperature	from -30 to +75
Maximum humidity	90%

DIMENSIONS

Diameter	50 mm
Length	260 mm

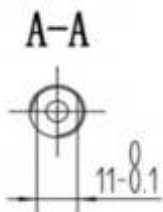
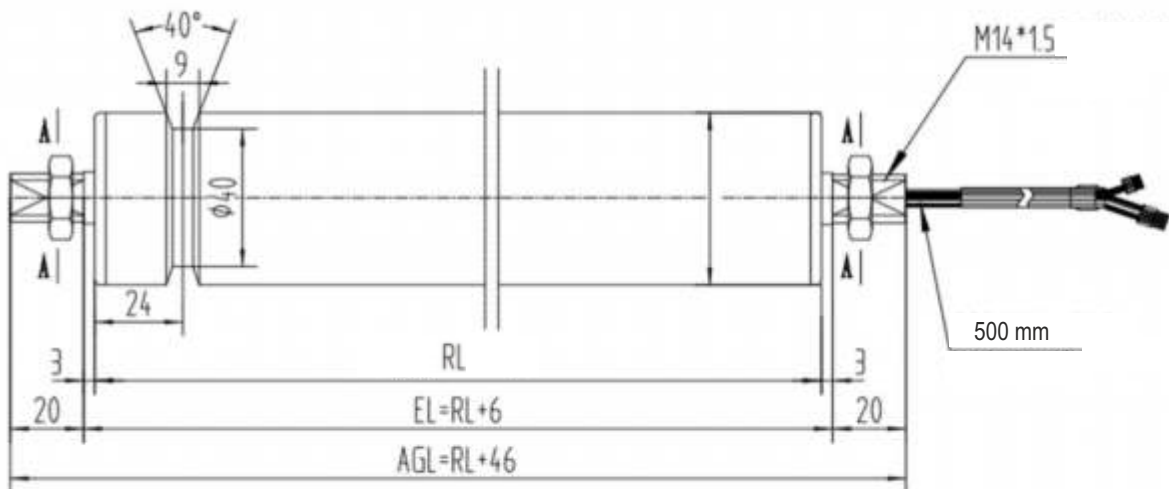

MOTOR ROLLER



TECHNICAL SPECIFICATIONS

Power	—	100 W
Voltage	—	24 V
Speed	—	9-230 m/min
Load capacity	—	up to 180 kg
Manufacturing material	—	stainless steel



TWO-ROW SPROCKET (08B14T)

Number of teeth	—	14
Pitch diameter	—	57,07
Standard hole	—	10 mm
Max. hole	—	24 mm
Hub diameter	—	42mm
Hub hole length	—	28 mm

OPERATING CONDITIONS

Temperature — from -10 to +40

Storage temperature — from -30 to +75

Maximum humidity — 90%

DIMENSIONS

Diameter — 76 mm

Length — 500 mm

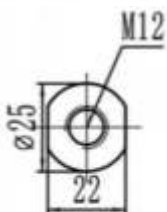
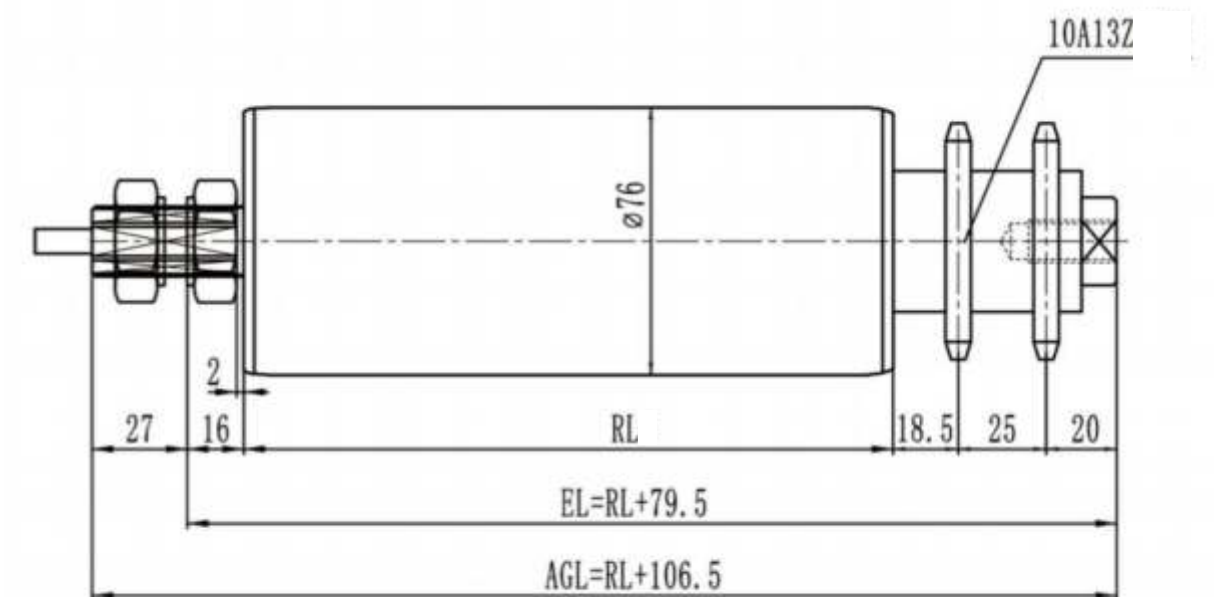

end

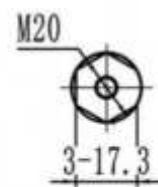

wire end

MOTOR ROLLER



TECHNICAL SPECIFICATIONS

Power	—	20 W
Voltage	—	24 V
Speed	—	8-116 m/min
Load capacity	—	up to 100 kg
Manufacturing material	—	stainless steel
	—	rubber coating



PULLEY FOR POLY-V BELT

Profile	—	PJ
Number of groves	—	9
Grove pitch	—	2,34
Belt thickness	—	21,06

OPERATING CONDITIONS

Temperature	from -10 to +40
Storage temperature	from -30 to +75
Maximum humidity	90%

DIMENSIONS

Diameter	43 mm
Length	500 mm

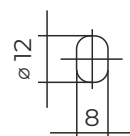
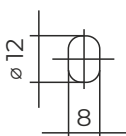
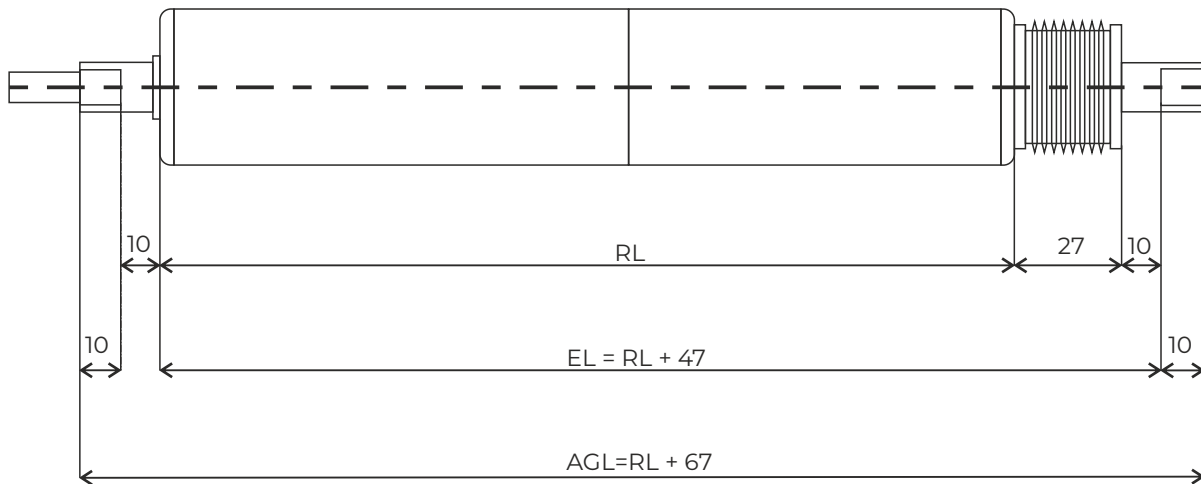

CONTROLLER

BCD-B-24-120A



Smart driver with variable speed control 24VDC



MAIN FUNCTIONS:



3 LED states

LED indication of error/alarm output signal



Selectable default rotation direction

The motor roller supports forward and reverse rotation



EBS/Servo brake support

Repeated recovery of working signal

Support for RS-485 communication via Modbus RTU protocol



Removable power and signal terminals

External switching between NPN and PNP modes

Connection to external voltage 0-10 V for variable speed control



Overheating and overcurrent protection of the drive board and motor roller

Internal 10 A fuse chip

Protection against incorrect power supply polarity

High voltage and low voltage protection



PID control and rotation speed control mode, 32 speed options

16 acceleration/deceleration settings

Variable speed control

Multi-segment speed can be configured

Open/closed loop operation speed

CONTROL

1	Power port	5	Speed control
2	External control port	6	6-bit function switch
3	Firmware port	7	Acceleration and braking control switch
4	Status indicators		

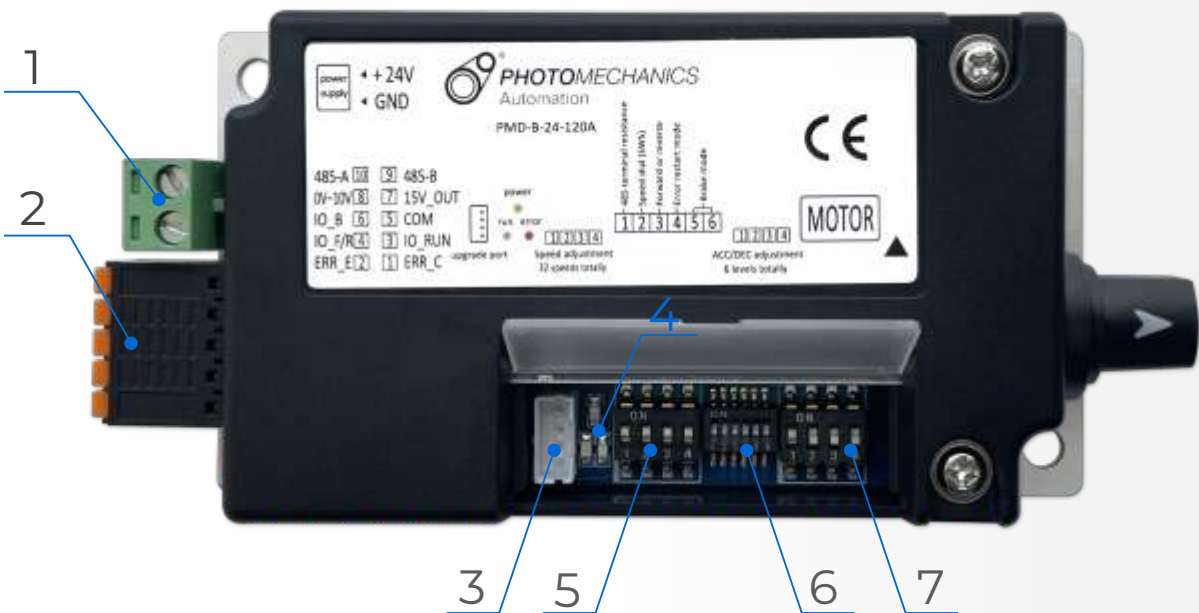

OPERATION ENVIRONMENT

Temperature	10~40°C
Relative humidity	10%~90% (non-condensing)
Height	below 1000 m
External vibration	less than 2G

DIMENSIONS

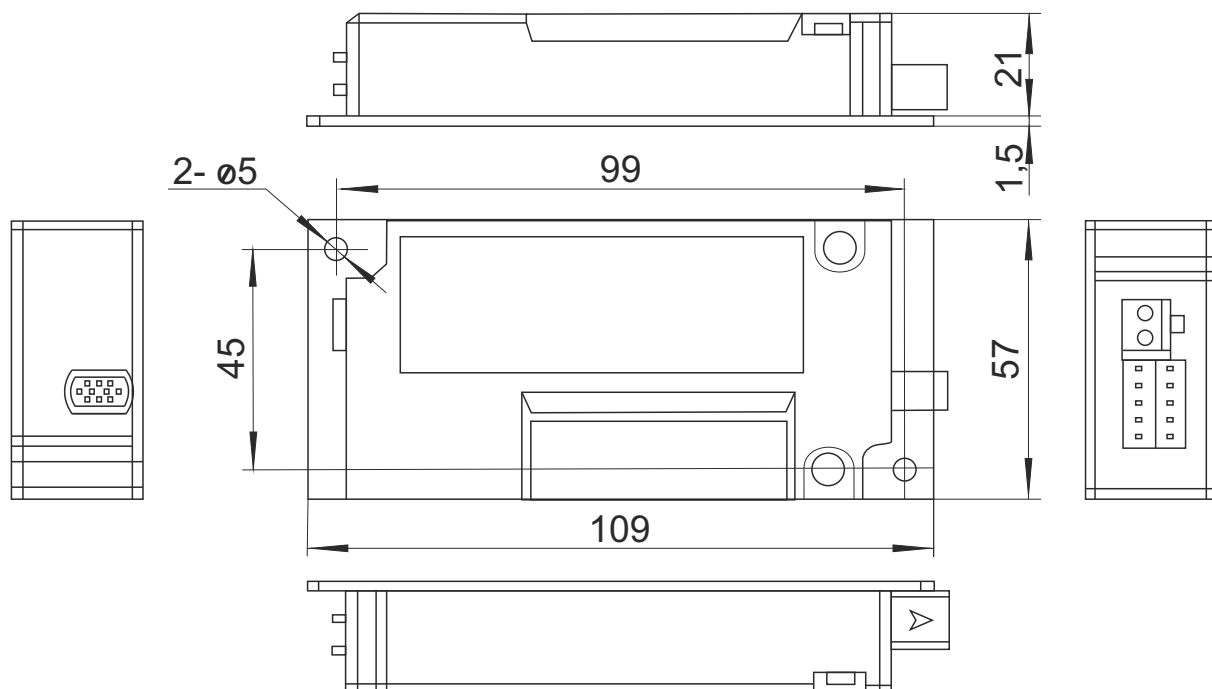



DRIVE AND GRAVITY ROLLERS



DIMENSIONS

Diameter	—	50 mm
Length	—	300 - 800 mm

TECHNICAL SPECIFICATIONS

Load capacity	—	up to 100 kg
Manufacturing material	—	stainless steel

GRAVITY ROLLER
PMA.RG.B.EL.5.2

Roller
mounting

internal
thread M8

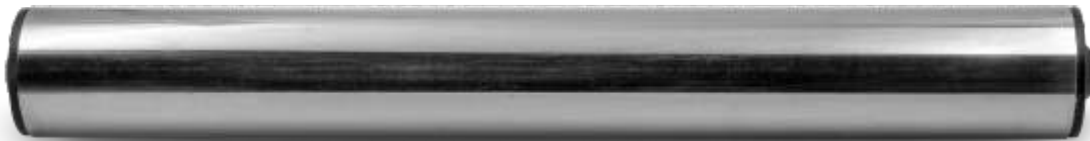
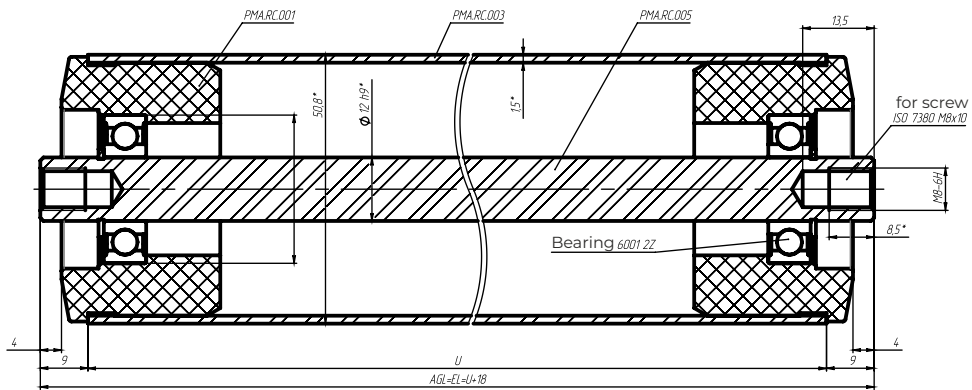

GRAVITY ROLLER
PMA.RG.B.EL.5.1

Roller
mounting

internal
axis 12 mm

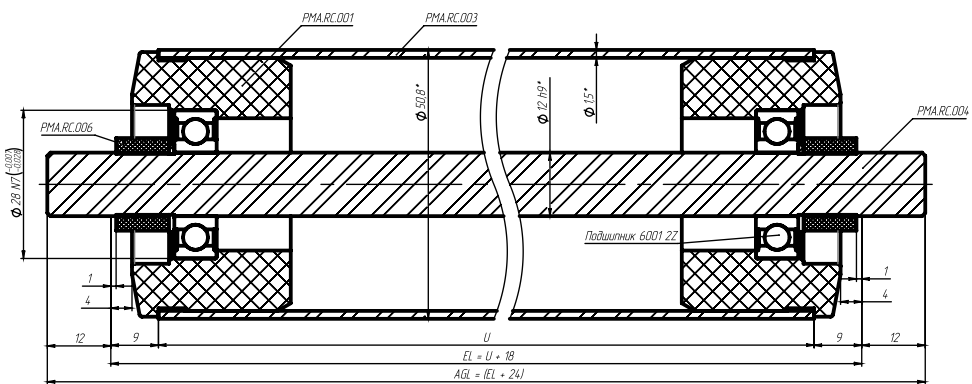

DRIVE ROLLER
PMA.RD.P.B.EL.5.2

Roller
mounting

internal
thread M8

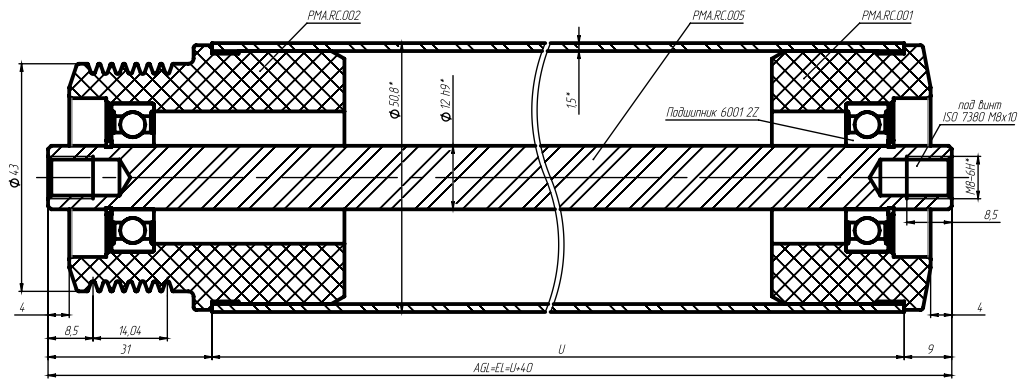

DRIVE ROLLER
PMA.RD.P.B.EL.5.1

Roller
mounting

internal
axis 12 mm

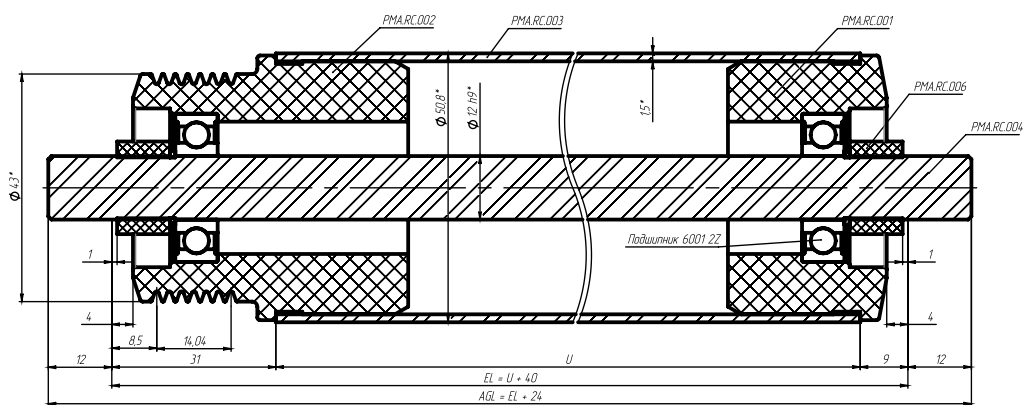

WE ARE TRUSTED BY



+1 (888) 877-3780
+44 (800) 520-0059
+381 (61) 193-0238
sales@photomechanics.com
www.photomechanics.com



Photomechanics
Jurija Gagarina 23, Office 329,
Belgrade, Serbia,
11070

